



Charles Sevrigh Way

£3,700 Per Month

Cosway Estates are pleased to offer for rent this fantastic modern four bedroom detached family home situated in popular well-sought after in Millbrook Park Development. This beautifully presented detached family home spans Circa 2,000 Sq ft and offers spacious, modern living across three floors.

On the ground floor, this property comprises of a stylish open-plan kitchen, dining, and living area, ideal for both everyday living and entertaining along with a utility room and guest W/C.

The first floor comprises of an additional reception room, a generous double bedroom with en-suite, and a separate W/C. The top floor comprises of three more double bedrooms and two further bathrooms.

Additional benefits include a separate garage, private driveway, and high-quality finishes throughout. Conveniently located within walking distance of Mill Hill East Station. AVAILABLE AUGUST 2026. Viewings highly advised.

- Circa 2000 Sq Ft - Detached House
- Excellent Condition
- 4 Double Bedrooms
- 2 Reception Rooms
- 3 Bathrooms
- Walking Distance To Mill Hill East Station
- Chain Free

Viewing

Please contact our Mill Hill Office on 02089590011 if you wish to arrange a viewing appointment for this property or require further information.



Floor Plan

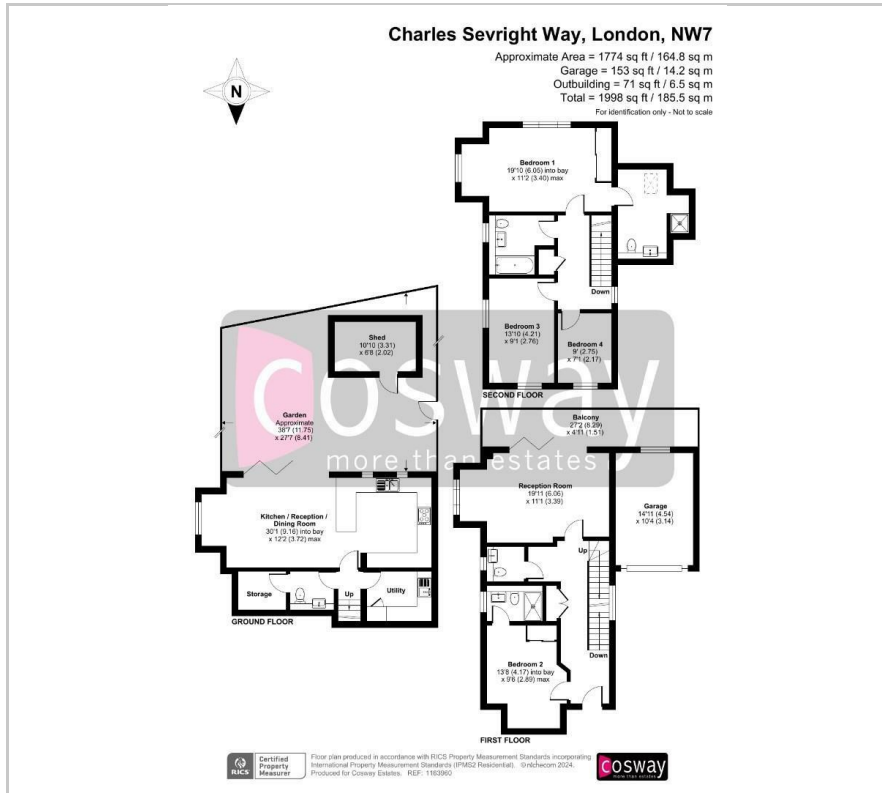

Area Map



Energy Efficiency Graph

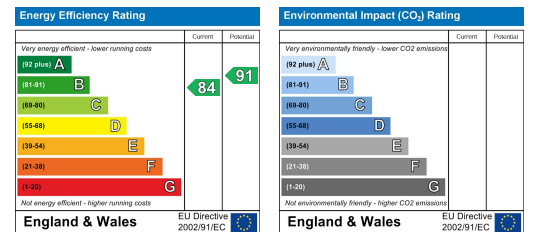

These particulars, whilst believed to be accurate are set out as a general outline only for guidance and do not constitute any part of an offer or contract. Intending purchasers should not rely on them as statements of representation of fact, but must satisfy themselves by inspection or otherwise as to their accuracy. No person in this firm's employment has the authority to make or give any representation or warranty in respect of the property.